

Manage your programme with our sensitive, cost effective and thorough approach to desktop ownership research

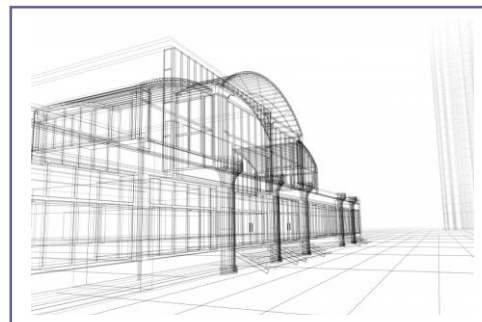

Early stage land ownership identification to support Master Planning, Strategic Housing and Regeneration decisions.

LRS have extensive experience in working in partnership with Councils, Developers and Regeneration Agencies to identify land ownership details in support of early stage decision making processes and assessment in the potential saleability of the site, in order to secure funding and the potential CPO or regeneration process.

The outputs of this desktop service will form a key part of evidence base needed to support:

- the development and appraisal of robust deliverable development options; Ultimate deliverability of the Area Action Plan.
- the development business case to inform and support capital investment in the development areas;
- Planning applications.

LRS desktop services provide:

- **Ownership information** in a format that is forward compatible with the CPO process and can incorporate a magnitude of other valuable information, such as environmental study, master planning, negotiation activities, valuation details, compensation details, land use, etc.
- **PDF layered plans**; this allows easy visualisation of the land ownership interest, extents and make-up. A useful tool, allowing the ability to interrogate the layer information to meet their needs. This is often used in presentations to help promote the scheme. An example of our layered PDF map can be found at www.land-referencing.co.uk

LRS are currently providing desktop services to:

- A major commercial and ancillary office development within Canary Wharf.
- A 106 site identification review for potential Strategic Housing Land Availability Assessment (SHLAA).
- A major highways CPO, Heysham to M6 Classified Road Bypass.
- A multi site coastal re development scheme.
- A housing regeneration project within L.B Tower Hamlets

